

PRELIMINARY

VER	DATE	APPRV	DESCRIPTION
1			ORIGINAL VERSION

PROBE	LENGTH
GPLP-4	28.0
GPLP-6	40.0
GPLP-8	52.0

DRILL AND TAP FOR 1.5" x 5/8-11 SET SCREW
 DRILL 17/32" x 0.800 DEEP
 TAP 0.750" DEEP

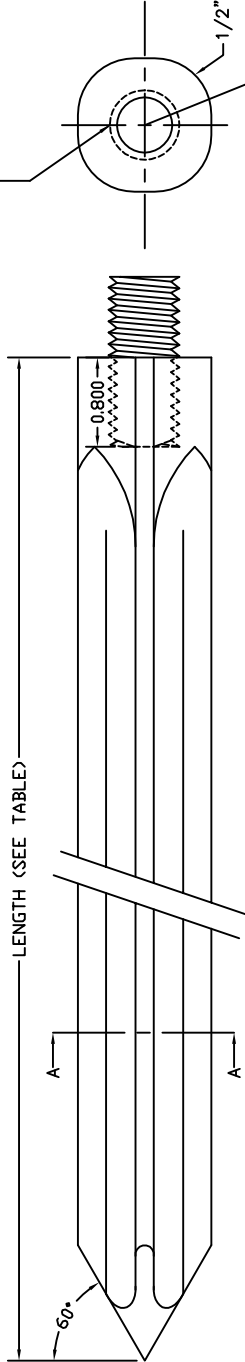

INSERT 1.5" x 5/8-11 SET SCREW AND FIX WITH LOCTITE

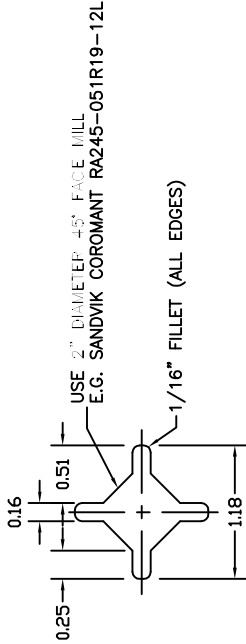

SECTION A-A

- NOTES :
1. MATERIAL - MILD STEEL BAR STOCK
 2. REMOVE BURRS, NO OTHER FINISH REQUIRED
 3. ALL DIMENSIONS ARE IN INCHES
 4. TOLERANCE ±0.01 UNLESS OTHERWISE STATED

RIOT TECHNOLOGY CORP. email: support@gropoint.com Tel:(250) 412-6642
 #217-10114 McDONALD PARK RD NORTH SAANICH BC CANADA V8L 5X8

THE INFORMATION CONTAINED WITHIN THIS DRAWING IS THE PROPERTY OF RIOT TECHNOLOGY CORP. IT IS NOT TO BE REPRODUCED, USED OR DISCLOSED IN WHOLE OR IN PART WITHOUT WRITTEN PERMISSION

INITIALS	DATE	TITLE:
BC	25APR14	GROPOINT GPLP PILOT ROD MACHINING DETAILS
DRAWN: BC	AutoCAD FILE	DWG/PART NUMBER : D0001152/#2554
INITIATED BY: BC	AutoCAD FILE	D0001152.DWG
SCALE: NONE		

SHEET 1